

**Mark S Feather** BSc M Arb (RFS) Tech Arbor A MICFor

Arboricultural, Woodland and Landscape Consultant

10 Grosvenor Place, Beverley, East Yorkshire HU17 8LY (01482 871064)

---

## **Landscape Management Plan**

Planning Application Number 19/00656/FUL

Malton Grange Country Park

Amotherby Lane

Amotherby

Malton

North Yorkshire

YO17 6UP

July 2019

### **Client**

Edwardson Associates

Paddock House

10 Middle Street East

Driffield

East Riding of Yorkshire

YO25 6 PT

## Contents

1.0	Introduction	3
2.0	Site Plan – (Plan 1A)	3
3.0	Existing Landscape Features	4
4.0	Arboricultural Implications Assessment – Landscape Impact Assessment	6
5.0	Landscape Proposals	8
6.0	Arboricultural Method Statement	10
7.0	Landscape Specification	11
	Appendix A – Tree Protection - Location Plan 4A	14

## 1.0 INTRODUCTION

- 1.1 This report provides information in accordance with British Standard 5837:2012 'Trees in Relation to Design, Demolition and Construction' for a proposed development at Malton Grange Country Park. The planning application is for the change of use of land to permit the siting of 8 timber clad cabin style caravans.
- 1.2 The arboricultural / landscape survey was commissioned by Edwardson Associates and is linked to the design work undertaken by them as planning consultants for the site. The aims of the survey were to undertake an assessment of all the existing trees within proximity of the proposed development, including trees on adjacent land.

## 2.0 SITE PLAN (Plan 1A)



3.0 EXISTING LANDSCAPE FEATURES

3.1 Existing Site Plan 2A



### 3.2 Schedule of Existing Landscape Features (Refer to plan 2A)

Reference	Species	Condition
<b>Hedge 1 (H1)</b>	Hawthorn (75%) Blackthorn (10%) Field Maple (10%) Ash 5%	Mature predominantly hawthorn hedge approximately 6m in height with the odd ash 8 – 9m in height. Odd wild rose within the hedge.
<b>Hedge 2 (H2)</b>	Hawthorn	Hawthorn hedge approximately 4m in height and 2m in width, regularly trimmed.
<b>Hedge 3 (H3)</b>	Hawthorn Ash 85% Oak 10% Willow 5%	Mature untrimmed hawthorn hedge approximate height 6m with high number of mature trees which gives the hedge a well treed appearance. The tree species are predominantly ash but with oak and an odd willow.
<b>Hedge 4 (H4)</b>	Hawthorn Blackthorn Ash 75% Oak 10% Field Maple 10% Horse Chestnut 5%	Mature untrimmed hawthorn and blackthorn hedge approximate height 6m with high number of mature trees which gives the hedge a well treed appearance. The tree species are predominantly ash but with oak, field maple and an odd Horse Chestnut.
<b>Group 1</b>	Willow Laurel	Mature little copse dominated by willow approximately 10m in height. Some ornamental shrubs (common laurel) planted within the bed.
<b>Woodland Planting Group A</b>	Mixed Native Woodland	Mixed native woodland planted at 2m to 4m spacing in lines. Trees are generally in the range of 6m to 10m in height. It is thought they would have been planted about 10 years ago. Species include, Ash, Lime, Scots Pine, Rowan, Field Maple, Birch, Alder, Sycamore, Hazel.
<b>Ornamental Shrub Planting</b>	Mixed ornamental shrubs	At the entrance to the site is mixed ornamental shrubs including, Laurel, Potentilla, Hebe, Pyracantha, Euonymus, Escallonia, Viburnum, Rosemary. Most are low up to 2m in height.



#### **4.1 Tree Removal and Pruning**

To enable the development an area of young woodland would require removal, part of woodland planting group A. This area consists of mixed native woodland planted at 2m to 4m spacing in lines. Trees are generally in the range of 6m to 10m in height. It is thought they would have been planted about 10 years ago. Species include, Ash, Lime, Scots Pine, Rowan, Field Maple, Birch, Alder, Sycamore, Hazel.

#### **4.2 Future Relationship with Trees**

The cabins would be located within the woodland area which would be the desired the setting for the cabins. The trees adjacent to the cabins in the long term have the potential to increase in size. Given the future growth of the trees and the close planting spacing it would be appropriate management to gradually thin the trees out which would preserve the setting of the lodges whilst not excessively over shadowing the cabins.

However, to maintain the lower screening to the cabins it is proposed to increase the native shrub element around the perimeter of the 8 cabin locations as shown on plan 3a. This planting could be undertaken following the clearance and installation of the units. Utilising native species, the new plating would quickly blend in with the native tree planting. The planting would help to increase the density of lower vegetation which would preserve the screening of the cabins from the highway during winter months.

#### **4.3 Root Protection Measures**

Given the age of the trees and the type of development proposed tree protection measures in the form of ridged fencing as normally used on development sites is not considered necessary. However, to ensure that the area of proposed tree removal has clearly marked out and agreed with the local authority it is recommend that the area for tree removal is marked out with a tight rope fixed at 1.2m above ground level utilising the trees to be retained and stakes where necessary. The rope to be wrapped with hazard tape and clearly labelled - 'Tree Protection Area - Do not Remove'.

#### **4.4 Construction and Storage Space / Services**

Adequate space exists to the installation of the cabins and services are to be located alongside the access road and would not be through the woodland area.

5.0 LANDSCAPE PROPOSALS

5.1 Landscape Plan 3A

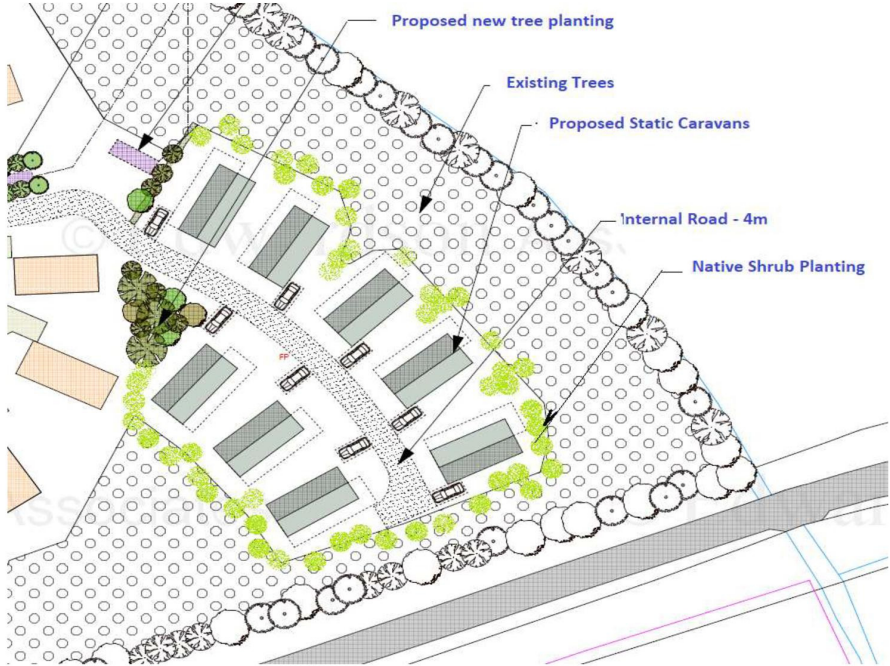



## 5.2 Schedule of Trees

Tree Planting	Tree Species (All containerised or root-balled)	Protection / Support / Planting notes	Girth	Number
	Field Maple ( <i>Acer campestre</i> ) Lime ( <i>Tilia cordata</i> ) Alder - ( <i>Alnus glutinosa</i> ) Oak ( <i>Quercus robur</i> )	The trees should be 6- 10cm diameter at 1m on stem and supported with a suitable stake and tie.  A 0.75m spiral guard should be used. The tree guard, stake and tie should be removed at an appropriate time, this is not expected to over 5 years.	6 - 10 cm  Trunk diameter	20 trees
Shrub Planting	Tree Species (All containerised or root-balled)	Protection / Support / Planting notes	Size	Number
	Hawthorn ( <i>Crataegus monogyna</i> , Hazel ( <i>Corylus avellane</i> Spindle ( <i>Euonymus europaeus</i> ) Guelder Rose ( <i>Viburnum opulus</i> ), Dogwood ( <i>Cornus sanguiniam</i> ), Holly ( <i>Ilex aquifolium</i> )	Shrubs should be planted at a density of approximately 2m spacing in any gaps in the woodland larger than 400 sq m.  The species of shrubs should be selected from the list below. Shrubs to be planted in species groups of 3 to 7 plants.  The shrubs should be protected with a 0.75m spiral guard and cane. Shrubs should be 40cm to 60cm size.	40 – 60cm  Size of seedling	200

## 6.0 ARBORICULTURAL METHOD STATEMENT (AMS)

### 6.1 General Site Management Constraints

- No soil stripping, excavation or removal is to take place other than within the area for the access road and locations for the cabins.

### 6.2 Local Planning Authority Meeting

- The Local Planning Authority to be notified not less than 72 hours prior to commencement of works on site. Existing trees to be removed to be marked or identified ready for Local Authority meeting. Tree protection boundary rope to be in position ready to agreed.

### 6.3 Removal of Existing Tree

- Existing trees to be removed following Local Authority meeting.

### 6.4 Erection of Tree and Hedge Protection Fencing

- The existing trees and hedges to be protected with tree protection fencing as illustrated on plan 4A. See appendix A

### 6.5 Construction Work

- With the tree protection fencing in place the construction work can commence.
- Services for the development are to be located as indicated on the plans with the service runs agreed with the architect and service providers before any excavation work commences.
- No site materials to be stored within the tree protection areas.

### 6.6 Completion of work.

- On completion of the construction work the tree protection fencing can be removed.
- Light cultivation of any bare ground may be required to enable seeding or turfing. Such light cultivation would not exceed 5cm and therefore have no impact on the existing trees.

## 7.0 LANDSCAPE SPECIFICATION

### 7.1 Site Preparation

- 7.1.1 Programme of Operation: The planting shall be installed over the minimum period to complete the whole of the works. Dates are subject to discussing and agreement with suitable environmental conditions prevailing. The Contractor must verify this programme of works before commencing on site.

### 7.2 Tree and Shrub Planting

- 7.2.1 Planting Operations: Planting operations shall be carried out in general accordance with the requirements of Sections 7, 8 and 9 of B.S. 4428: 1989 'Recommendations for General Landscape Operations (Excluding Hard Surfaces)'.
- 7.2.2 Damage: All plants shall be adequately and carefully packed and protected to survive transport, by whatever means, to the site without damage in loading, transit or un-loading. If in spite of these precautions, roots, branches or shoots suffer slight damage, they shall be carefully pruned. If major damage has occurred, the plant shall be rejected and replaced.
- 7.2.3 Container and Pot Grown plants: Container and pot grown shrubs must have grown in weed free containers of the sizes specified for at least one complete growing season and must be healthy, bushy, vigorous and well-rooted but not pot bound and equal to all clauses of this specification.
- 7.2.4 Species and Varieties: All plants are to be of the species and variety indicated on the schedules and drawings. If however, any plants are unobtainable at the time of ordering, the contractor is to inform the Employer immediately and submit a list of alternatives for consideration.  
Container and pot grown plants which are not planted on arrival on site must be watered frequently to prevent drying out. Plants which have been allowed to dry out to the extent where their health is affected will be replaced at the Contractor's expense.  
Immediately before planting, all container and pot grown plants will be well watered. Care will be taken during planting not to break up the rootball. Where plants have become pot bound, the roots on the outside of the ball will be gently eased out before planting.
- 7.2.5 Heeling In: After delivery, if planting is not carried out immediately, root balled plants shall be placed cheek to cheek and the ball covered with sand or fine soil and watered to prevent drying out. Bare rooted plants shall be heeled-in by placing the roots in a prepared trench and covering them with fine soil which shall be watered in to avoid air pockets round the roots.

- 7.2.6 Planting shrubs: Dig out holes large enough to receive the roots of the plant fully extended and well spread out. Carefully work top-soil among roots and backfill. Plants to be well firmed by heeling and the surface left neat and even. Planting must be to the same depth as in the nursery. Care must be taken not to disturb the root balls of pot grown plants and not let any roots dry out at any time.
- 7.2.7 Watering: trees and shrubs shall be well watered in immediately after planting.
- 7.2.8 Tree Pits: Tree pits shall be of a diameter 600mm greater than the root ball. The depth of the pit shall be 225mm deeper than the root ball and not less than 600mm deep. The base of the tree pit shall be forked over to a depth of 225mm.
- 7.2.9 Tree Stock: All stock must comply in all respects with the current edition of B.S. 3936. Trees shall be well grown nursery stock free from disease, true to type and of a size scheduled in accordance with the approved method of measurement.
- 7.2.10 Planting Trees: The tree must be planted to the same depth as in the nursery, and to the same orientation. The trees should be backfilled with topsoil, firmly heeling in the soil as filling proceeds until the finished ground level is reached.
- 7.2.11 Stakes: To be requisite length, pressure impregnated (with preservative non injurious to plants) de-barked softwood 100mm square or diameter.
- 7.2.12 Tree Ties: To be plastic ties "Toms" pattern, two per stake and nailed to stake with large head galvanised nails.
- 7.2.13 Planting Season: Unless otherwise specified all transplanting shall be carried out between the end of October and the end of March. Container grown trees may be transplanted at times other than these at the discretion of the client/ Contract Manager. The transplanting shall be carried out when the weather is dull and the ground is moist and workable. On no account must the planting take place when there is freezing wind. Where approval is given by the developer to transplant between March and September, the trees shall be given a transplanting spray before transplanting and again between 7 and 10 days after planting, at the Contractor's expense.
- 7.2.14 Transplanting in Frosty Conditions: Planting of trees in frosty conditions will only be permitted if adequate precautions are taken. The prepared root balls must have additional wrapping. The bottom and sides of the tree pits, and the piles of top-soil, must be protected from freezing by the use of boards, tarpaulins or other approved materials.
- 7.2.15 Watering: During dry conditions trees and shrubs shall be well watered especially where container plants are used outside the winter planting season.

7.2.16 Planting Method – Bare root fibres will be kept moist at all times. All plants are to be planted so that the top of the nursery mark is level with the final soil level. All hedge plants will be planted vertically using small pits or notch planting.

**7.3 Programme of implementation**

7.3.1 Planting to be undertaken during the first planting season October – March following completion of building work unless otherwise agreed.

**7.4 Maintenance**

7.4.1 A programme of maintenance will ensure that all trees that fail to make active growth are replaced during the first available planting season for the first 3 years.

7.4.2 During March, an application of Glyphosate will control competitive weeds and grass around trees and hedges for the first 3 years after planting. A weed free zone of 1 metre around each hedge will be adequate. Glyphosate is a non-selective herbicide that is absorbed through leaves. The chemical should be applied by someone who has a relevant pesticide application certificate.

Appendix A – Tree Protection (Plan 4A)

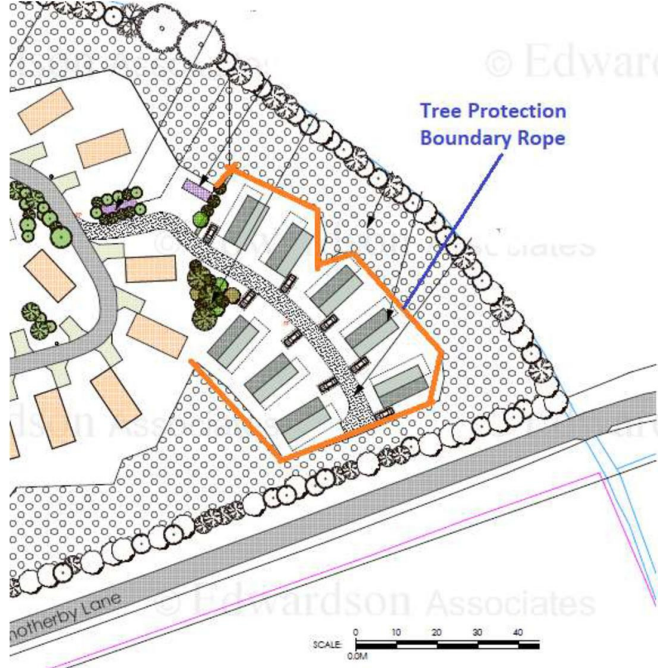

Boundary rope to be 10mm in size with hazard tape wrapped round.